

350

JUDAH

SAN FRANCISCO, CALIFORNIA



# 350 JUDAH

SAN FRANCISCO, CALIFORNIA

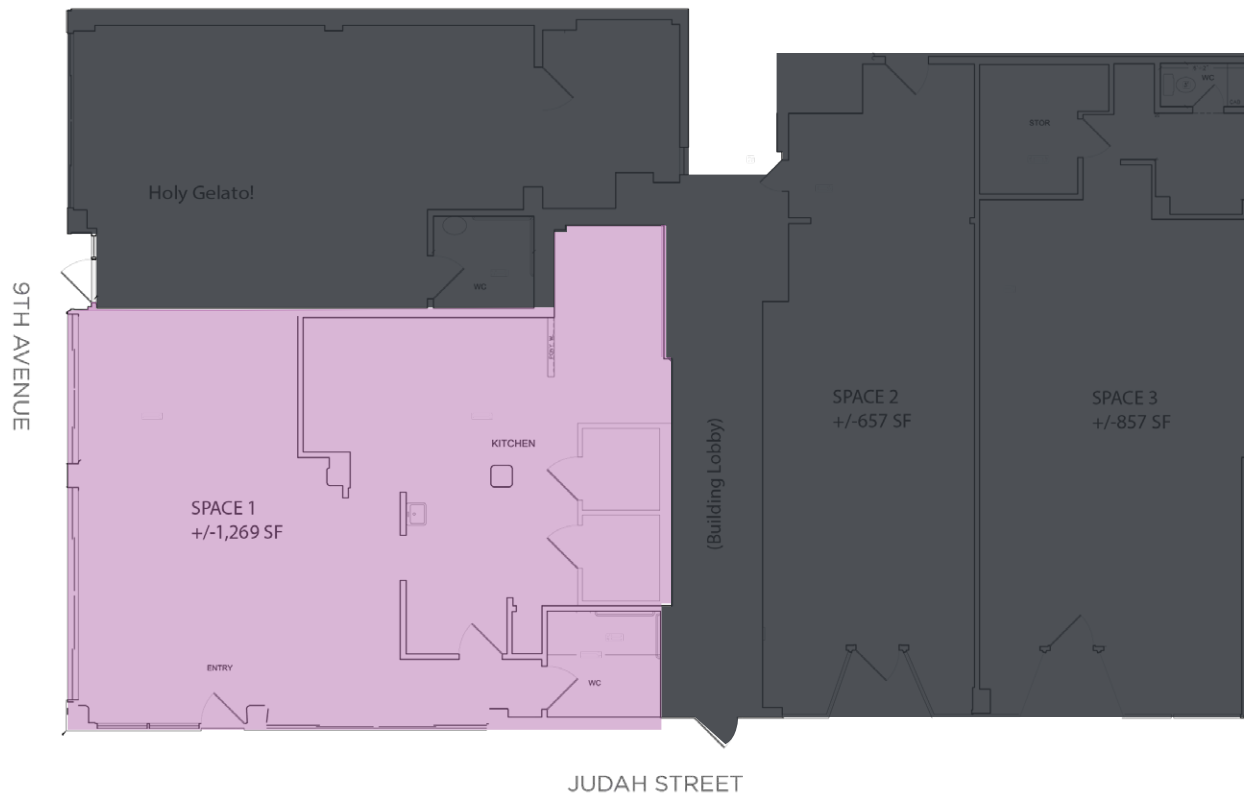

- Highly visible corner building
- Served by four Muni lines
- Two blocks from Golden Gate Park
- 50+ feet of frontage on Judah and 9th Avenue
- Excellent visibility and signage
- 1-mile population: 48,000
- UCSF enrollment: 3,000+

Zoning:

Inner Sunset District





Judah

Puff Bakery

5th AVE

43 NASOMC  
Menlo + Genoa

099

8433

maven  
RETAIL

# 350 JUDAH

SAN FRANCISCO, CALIFORNIA

- Inner Sunset Neighborhood:
- A favorite neighborhood of long-time native San Franciscans
- Diverse ethnic mix and mellow community feel
- Young families mingle with UCSF students and Bay Area diners in funky cafes and eateries
- Year-round cyclists, dog-walkers, and picnickers 2 blocks away in San Francisco's landmark, Golden Gate Park
- 350 Judah Street Retail Spaces:
- 6-level multi-family building includes 34 units
- Convenient access to 4 Muni public transit lines
- Steps away from the thriving 9th Ave and Irving shops and restaurants

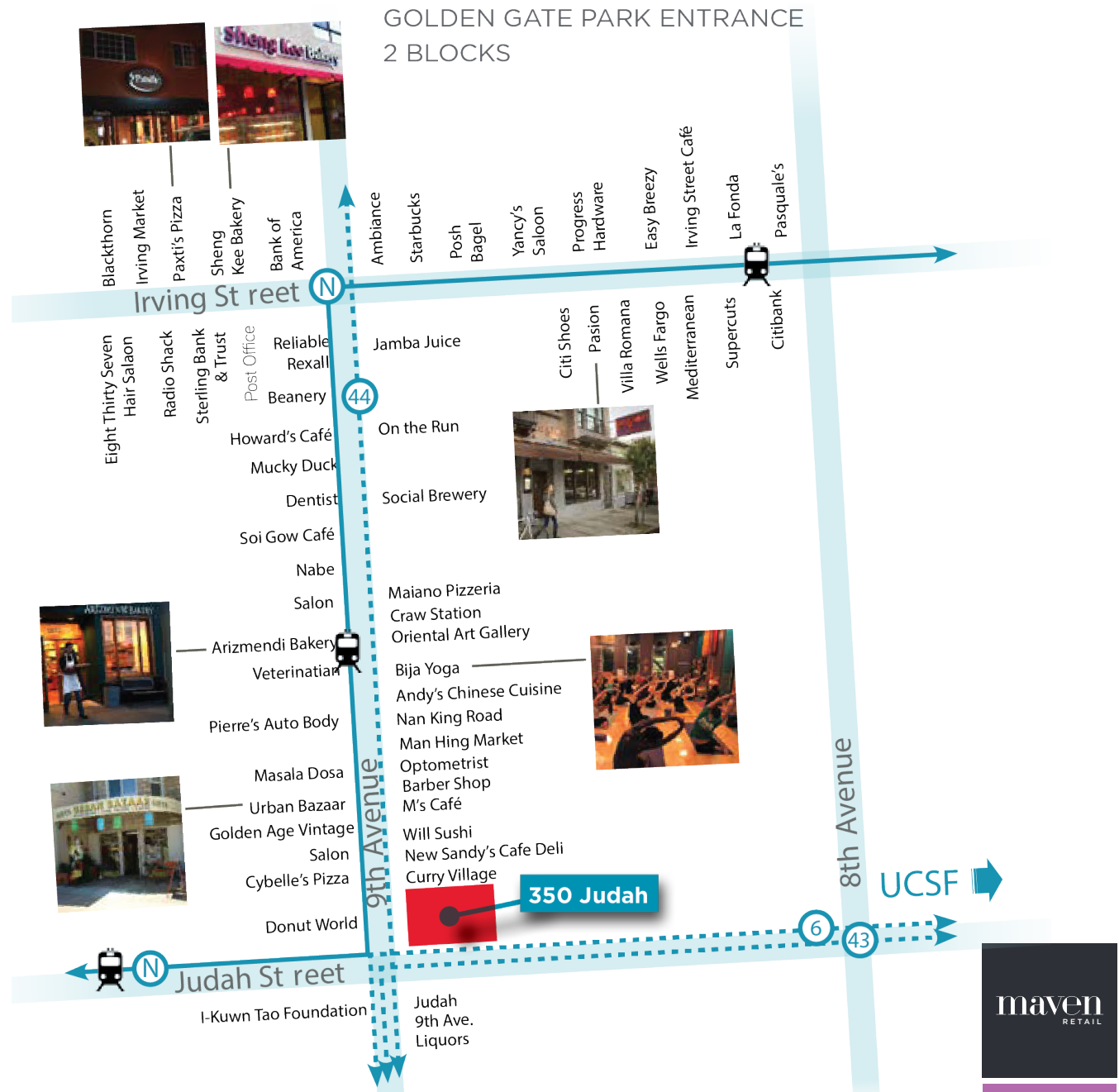

# 350 JUDAH

SAN FRANCISCO, CALIFORNIA

maven  
RETAIL • OFFICE • INDUSTRIAL

**SARAH BRETT SCHWARTZ**  
office 415.404.6959  
sarah@mavenproperties.com  
DRE #01903152

**PAM MENDELSON**  
office 415.404.6650  
pam@mavenproperties.com  
DRE #00953050

NOTICE: This information has been secured from sources we believe to be reliable but we make no representations, warranties, express or implied, as to the accuracy of the information. Listing broker has been given enough information to provide only a preliminary interest in the property. The materials are not to be considered fact. The information contained herein is not a substitute for thorough due diligence investigation. References to square footage, zoning, use, or age are approximate. Please contact the San Francisco Planning Department to verify zoning at (415) 558-6378, as neither broker or landlord represent that this space is suitable for your use. Tenant or Buyer must verify the information at their own expense and bears all the risk for any inaccuracies. By receiving these materials you are agreeing to the disclaimers set forth herein. DRE#01878802

---

466 Green Street Suite #203 | San Francisco, CA 94133 | 415.781.7700