

2700

SUTTER

GROUND FLOOR COMMERCIAL SPACE

SHORT TERM/POP UPS WELCOME



maven
RETAIL

FEATURES

- +/- 1,276 SF
- Short Term/Pop Ups Welcome
- Additional storage space available
- Beautiful San Francisco Victorian building
- Abundant sunlight
- High Ceilings
- Period details throughout
- Private bathroom with shower
- Suitable for a variety of uses
- Close to public transportation

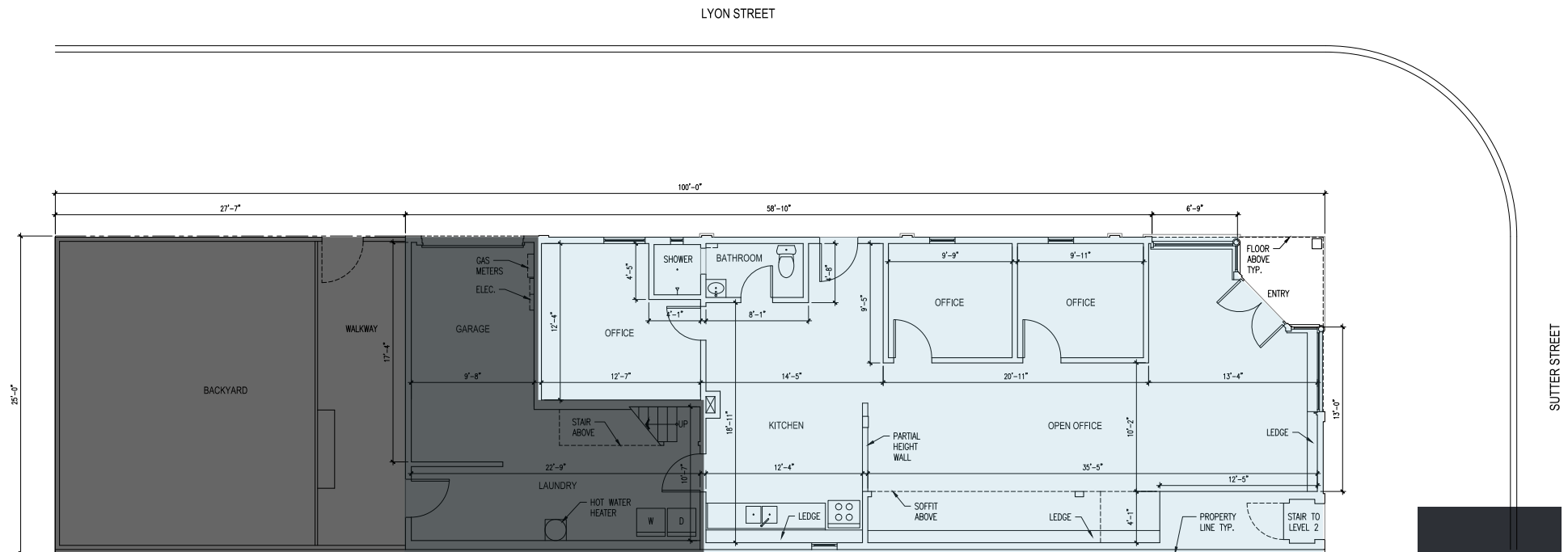







Consulate General of the Republic of Korea

Presidio Heights Playground

And Something Blue

Jewish Community Center of San Francisco

Vogue Theatre

Presidio Branch Library

The Mindful Body

B. on the Go

Dr. William L. Cobb Elementary School



Drew School

Ella's American Kitchen

YogaWorks San Francisco

The San Francisco Athletic Club

UCSF Medical Center at Mount Zion

Russian Center of San Francisco

UCSF Laurel Heights Campus

San Francisco Fire Department Museum

2700

SUTTER



Quoted

A Runner's Mind

One Medical

Beautiful

Chico's

Laurel Hill Playground

Gadar Memorial

Firestone Complete Auto Care

Sunstream Coffee

Self Service Car Wash

Ro Cafe

Tofino Wines

Tony's Cable Car

Kaiser Permanente San Francisco Medical...

Subway Restaurants

Ulta Beauty

Zazang Korean Noodles

Kaiser Permanente Pharmacy

Xfinity Store by Comcast

Western Addition Library

Gateway High

Raoul Wallenberg Traditional High School



2700

SUTTER



TARGET



TRADER JOE'S



TONY'S CABLE CAR



ELLA'S AMERICAN KITCHEN

maven
RETAIL

NEIGHBORHOOD



SAN FRANCISCO ATHLETIC CLUB



YOGA WORKS



GODZILLA SUSHI

2700

SUTTER

GROUND FLOOR COMMERCIAL SPACE

maven
RETAIL • OFFICE • INDUSTRIAL

DOMINIC MORBIDELLI

office 415.404.7314

dom@mavenproperties.com

BRE # 02024348

JOAN RUYLE

office 415.404.7313

joan@mavenproperties.com

BRE #02006025

SANTINO DEROSE

office 415.404.7337

sd@mavenproperties.com

BRE #01338326

NOTICE: This information has been secured from sources we believe to be reliable but we make no representations, warranties, express or implied, as to the accuracy of the information. Listing broker has been given enough information to provide only a preliminary interest in the property. The materials are not to be considered fact. The information contained herein is not a substitute for thorough due diligence investigation. References to square footage, zoning, use, or age are approximate. Please contact the San Francisco Planning Department to verify zoning at (415) 558-6378, as neither broker or landlord represent that this space is suitable for your use. Tenant or Buyer must verify the information at their own expense and bears all the risk for any inaccuracies. By receiving these materials you are agreeing to the disclaimers set forth herein. BRE#01878802

466 Green Street Suite #203 | San Francisco, CA 94133 | 415.781.7700