

1157

VALENCIA



MISSION DISTRICT RETAIL FOR LEASE

maven  
RETAIL

## FEATURES

- +/- 600 SF
- Open floor plan
- Located in eclectic Valencia/Mission neighborhood
- Close proximity to to 24th Street BART station
- Neighbors include Arizmendi, Beretta, Ritual Coffee, UP For Dayz Coffee Shop, Yoga Tree Valencia, SF City College Mission Campus
- \$2,800/Mo (MG)

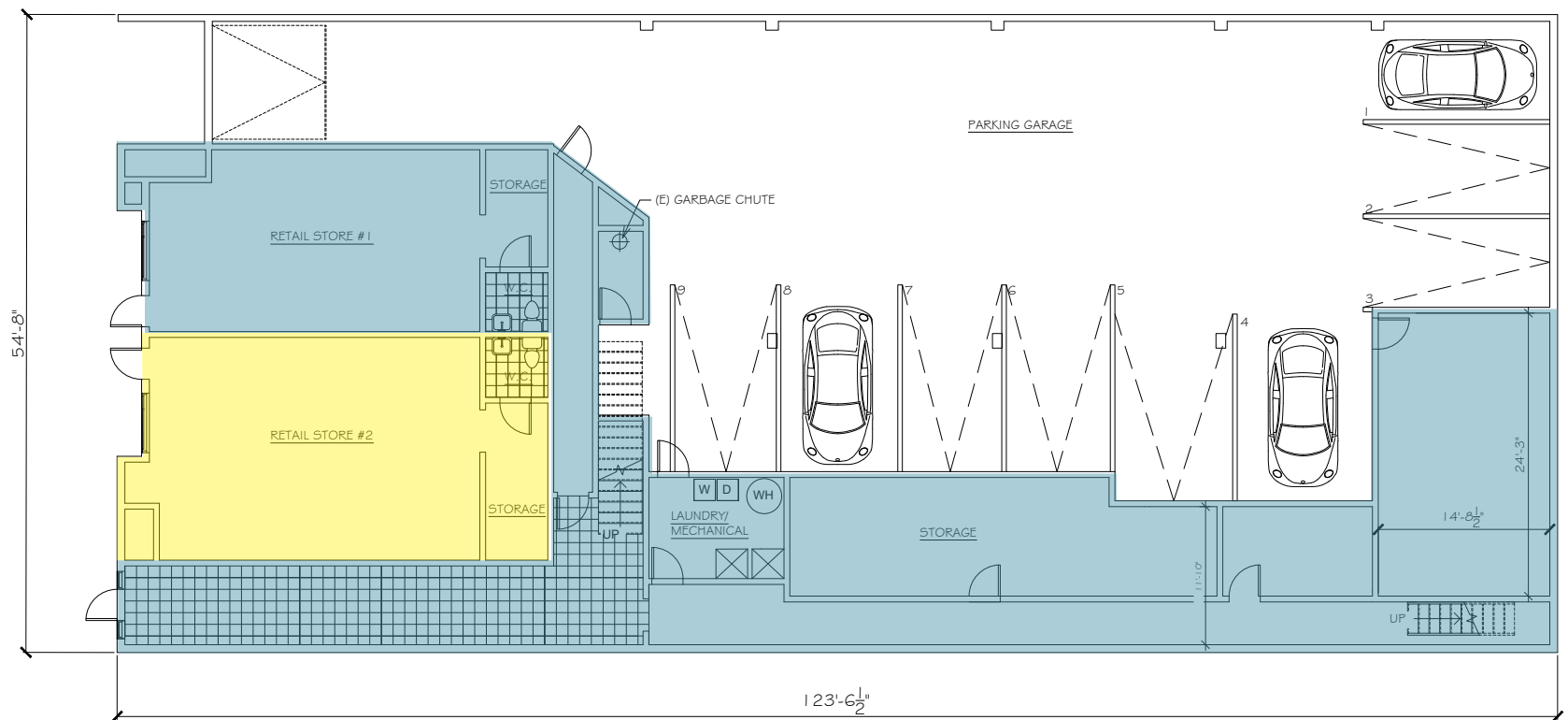

# 1157 | VALENCIA • *Notable Neighbors*



**STRANDED RECORDS**



**UDUPI PALACE**



**VALENCIA CYCLERY**

21st STREET	
Optometry Available Jungmans Appliance (Available) Ritual Coffee Audery 1-2-3-4 Go! Harvey Real Estate	1000 1018 1026 1034 1038 1048
Apts Marsh Theater	1058 1062
US Social Security Administration	1098
Boogaloos	3296 22nd St.
22nd STREET	
Luccà's Ravioli Co.	1100
The Crepe House Zaytoon Mediterranean Wraps	1132 1136
U-Save Plumbing & Hardware	1146
Sugoi Sushi Salvation Army	1152 1156
Wallflower New Development	1176
1101 1109	Garçon French Restaurant Radio Habana
1125	CCSF Mission Campus
1153 1155	El Valenciano All Cities Real Estate
1169	Love Lux
1173	Needles & Pems
1193 1199	Scarlet Sage Herb Co. Beretta
23rd STREET	
Mr. Liquor Buffalo Exchange Cut Loose Tenpo de la Fe Church YogaTree	1200 1210 1218 1234
Mercado Brazil R&A Cleaners Available Arizmendi Bakery Barzotto	1252 1264 1266 1268 1270
1299	Horace Mann Middle School Valencia Farmer's Market
24th STREET	



maven  
RETAIL

# NEIGHBORHOOD



1157

VALENCIA

**MISSION DISTRICT RETAIL FOR LEASE**

**maven**  
RETAIL • OFFICE • INDUSTRIAL

**HALEY KLEIN**

**415.404.7330**

**haley@mavenproperties.com**

**BRE #01907308**

**SANTINO DEROSE**

**415.404.7337**

**sd@mavenproperties.com**

**BRE #01338326**

NOTICE: This information has been secured from sources we believe to be reliable but we make no representations, warranties, express or implied, as to the accuracy of the information. Listing broker has been given enough information to provide only a preliminary interest in the property. The materials are not to be considered fact. The information contained herein is not a substitute for thorough due diligence investigation. References to square footage, zoning, use, or age are approximate. Please contact the San Francisco Planning Department to verify zoning at (415) 558-6378, as neither broker or landlord represent that this space is suitable for your use. Tenant or Buyer must verify the information at their own expense and bears all the risk for any inaccuracies. By receiving these materials you are agreeing to the disclaimers set forth herein. BRE#01878802

**466 Green Street Suite #203 | San Francisco, CA 94133 | 415.781.7700**