

• 560 •
CENTRAL AVE
SAN FRANCISCO, CA



maven
RETAIL

FEATURES

- +/- 1,424 SF ground floor plus +/- 398 SF Basement
- Second generation restaurant
- Type 41 liquor license (beer & wine) may be transferable
- Heated outdoor seating
- Walk-In refrigerator
- No key money!
- Close proximity to USF, Lucky's, Starbucks, Barrel Head Brewhouse, the Panhandle, and many other businesses.

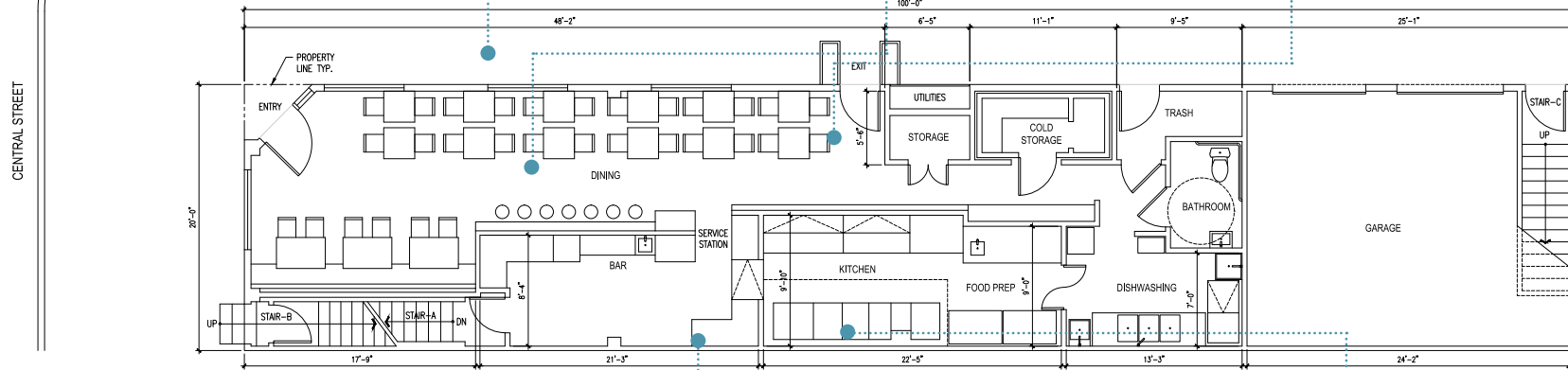

Ground Floor Plan

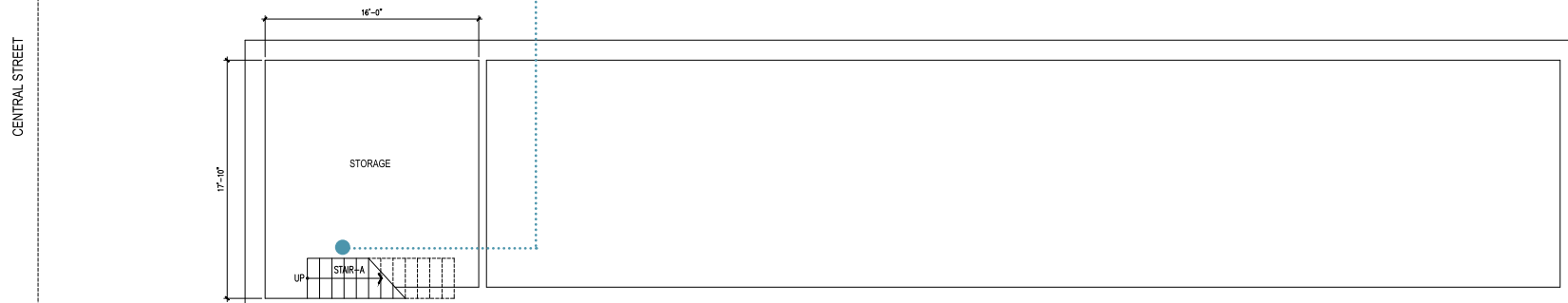

Basement Floor Plan

• 560 •
CENTRAL AVE
SAN FRANCISCO, CA





BARREL HEAD BREWHOUSE



RAGAZZA



BISTRO GAMBRINUS

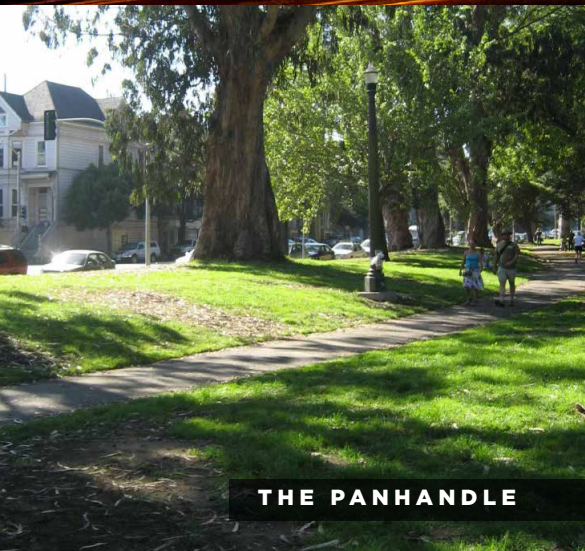

THE PANHANDLE



WHOLE FOODS



BEND YOGA STUDIO



BRENDA'S MEAT AND THREE



NOPA



4505 BURGERS & BBQ

• 560 •
CENTRAL AVE
SAN FRANCISCO, CA

maven
RETAIL • OFFICE • INDUSTRIAL

JOAN RUYLE

415.404.7313

joan@mavenproperties.com

DRE #02006025

PAM MENDELSON

office 415.404.6650

pam@mavenproperties.com

DRE #00953050

NOTICE: This information has been secured from sources we believe to be reliable but we make no representations, warranties, express or implied, as to the accuracy of the information. Listing broker has been given enough information to provide only a preliminary interest in the property. The materials are not to be considered fact. The information contained herein is not a substitute for thorough due diligence investigation. References to square footage, zoning, use, or age are approximate. Please contact the San Francisco Planning Department to verify zoning at (415) 558-6378, as neither broker or landlord represent that this space is suitable for your use. Tenant or Buyer must verify the information at their own expense and bears all the risk for any inaccuracies. By receiving these materials you are agreeing to the disclaimers set forth herein. DRE#01878802

466 Green Street Suite #203 | San Francisco, CA 94133 | 415.781.7700