

680 | MISSION | SAN FRANCISCO, CALIFORNIA
RETAIL OPPORTUNITY

JOAN RUYLE
CELL: 415.471.8504
OFFICE: 415.404.7313
joan@mavenproperties.com
DRE #02006025

KRYSTAL CHANNICK
CELL: 858.231.2299
OFFICE: 415.462.5940
krystal@mavenproperties.com
DRE #01969079

maven
RETAIL

Features:

- +/- 504 SF
- Café Infrastructure
- Glass Frontage
- Recent Improvements
- Abundant Natural Light
- Nearby retailers and restaurants include: The Grove, Novela, The Bird, Trou Normand, Super Duper Burgers, The St. Regis, Peet's Coffee, and many more.

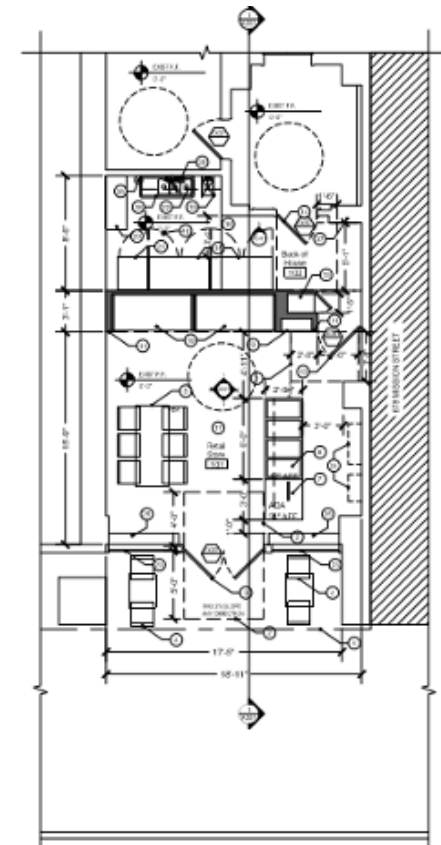

- Mission Street -

Floor Plan Proposed







680 | MISSION | SAN FRANCISCO, CALIFORNIA

RETAIL OPPORTUNITY

JOAN RUYLE
CELL: 415.471.8504
OFFICE: 415.404.7313
joan@mavenproperties.com
DRE #02006025

KRYSTAL CHANNICK
CELL: 858.231.2299
OFFICE: 415.462.5940
krystal@mavenproperties.com
DRE #01969079

NOTICE: This information has been secured from sources we believe to be reliable but we make no representations, warranties, express or implied, as to the accuracy of the information. Listing broker has been given enough information to provide only a preliminary interest in the property. The materials are not to be considered fact. The information contained herein is not a substitute for thorough due diligence investigation. References to square footage, zoning, use, or age are approximate. Please contact the San Francisco Planning Department to verify zoning at (415) 558-6378, as neither broker or landlord represent that this space is suitable for your use. Tenant or Buyer must verify the information at their own expense and bears all the risk for any inaccuracies. By receiving these materials you are agreeing to the disclaimers set forth herein. DRE#01878802

466 Green Street Suite #203 | San Francisco, CA 94133 | 415.781.7700