

# 1999 HARRISON STREET

OAKLAND | CALIFORNIA



LAKE MERRITT  
PLAZA

maven  
RETAIL

RESTAURANT / RETAIL OPPORTUNITIES

THE HEART OF UPTOWN

## THE PROPERTY

*1999 Harrison Street*

Lake Merritt Plaza is a Class-A, 27 story office tower and a smaller 4 story office building located in Oakland's Uptown District featuring panoramic views of Lake Merritt and located on the heavily trafficked intersections of 20th Street, Webster Street and Harrison Street adjacent to Snow Park.







## ..... FEATURES .....

- Class A 27-story office tower in the heart of Oakland's Uptown District
- Existing 6,000 occupants in immediate area with 1.5m SF of office
- Across from Lake Merritt.
- Centrally located within Oakland's Office District and mixed-use residential developments
- Surrounded by 10.7m SF office and over 6k residential units within blocks
- Easy access to public transportation
- Large dedicated retail seating area adjacent to available space





# SITE PLAN

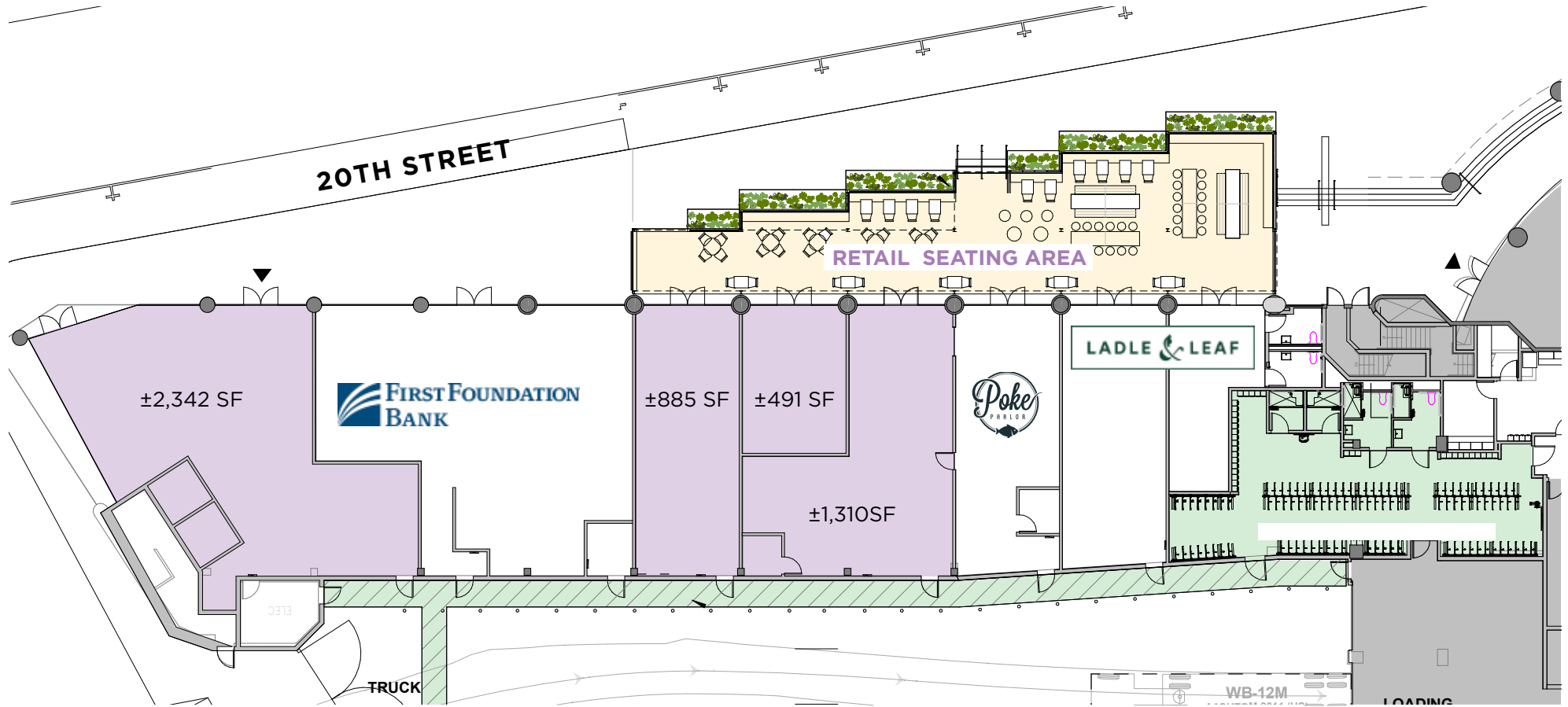

## .....OAKLAND.....

The perfect blend of urban convenience and neighborhood charm. Just moments from Lake Merritt, this desirable location boasts easy access to lush parks, scenic walking trails, and some of Oakland's best dining, shopping, and entertainment.

Enjoy a serene, tree-lined street with a true community feel—all while being minutes from downtown Oakland, Grand Avenue, and the bustling Saturday Farmers Market. Commuters will appreciate proximity to BART, AC Transit, and quick freeway access.



**FOX THEATRE**



**LAKE MERRITT PATH**



**HELLO STRANGER**



**LUCUMA KITCHEN & BAR**



**THE TERRACE ROOM**



**LAKE CHALET SEAFOOD GRILL**



**CUPCAKIN' BAKE SHOP**



**LAKESIDE PARK GARDEN**



**CRYBABY**



**BOCANOVA**



**MIHARU ICE CREAM**



**OAKLAND CITY HALL**



# NEIGHBORHOOD

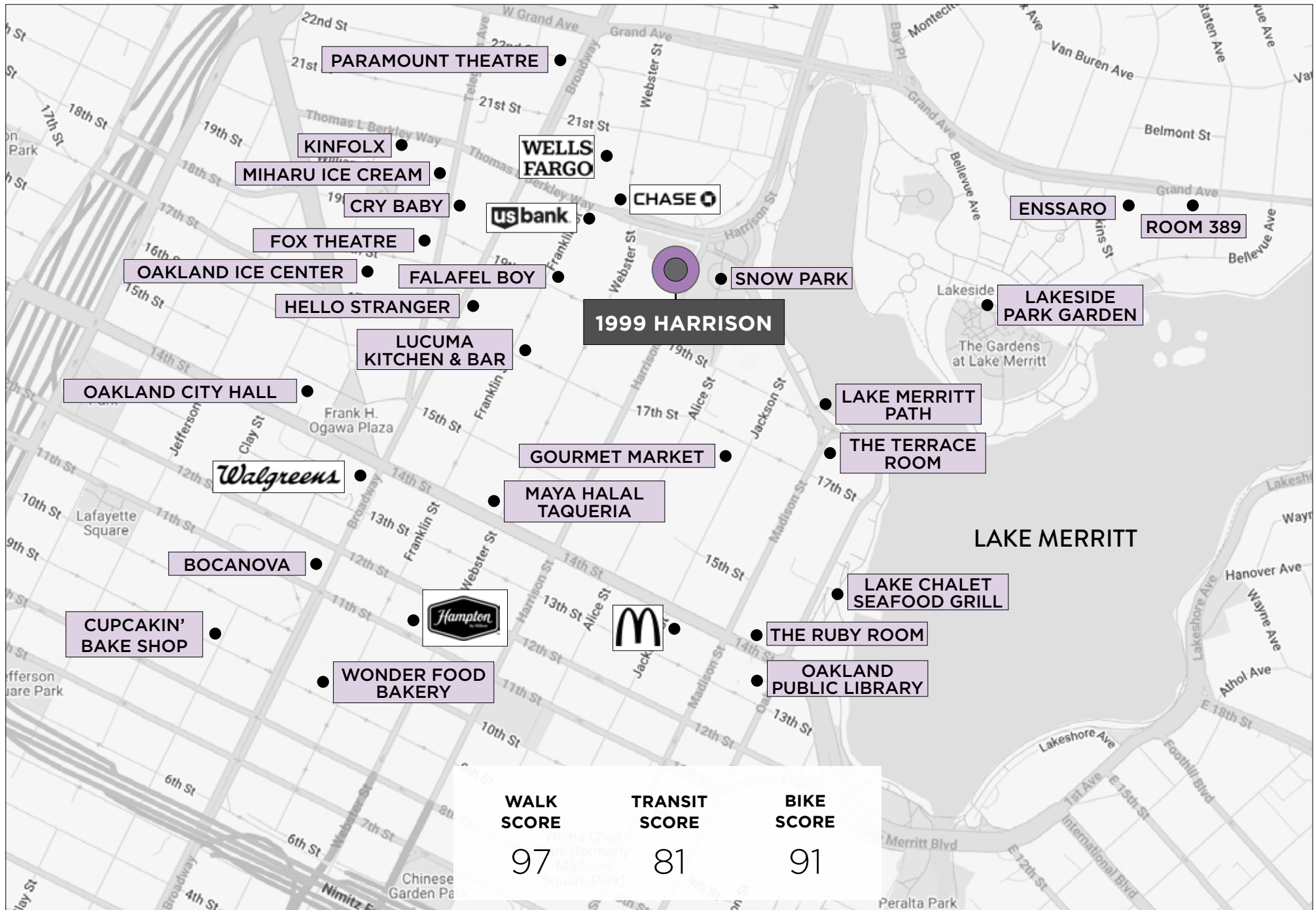

# 1999 HARRISON

OAKLAND | CALIFORNIA

maven  
RETAIL

## Contacts

.....

**NADINE WHISNANT**  
office 510.413.7813  
nadine@mavenproperties.com  
DRE #00966437

.....



LAKE MERRITT  
PLAZA

NOTICE: This information has been secured from sources we believe to be reliable but we make no representations, warranties, express or implied, as to the accuracy of the information. Listing broker has been given enough information to provide only a preliminary interest in the property. The materials are not to be considered fact. The information contained herein is not a substitute for thorough due diligence investigation. References to square footage, zoning, use, or age are approximate. Please contact the San Francisco Planning Department to verify zoning at (415) 558-6378, as neither broker or landlord represent that this space is suitable for your use. Tenant or Buyer must verify the information at their own expense and bears all the risk for any inaccuracies. By receiving these materials you are agreeing to the disclaimers set forth herein. DRE#01878802

466 GREEN STREET SUITE #203 | SAN FRANCISCO, CA 94133  
415-781-7700 | [www.mavenproperties.com](http://www.mavenproperties.com)