

962 VALENCIA

SAN FRANCISCO



maven
RETAIL

962 VALENCIA



FEATURES

- 1,700 SF
- Corner Valencia Street location between 20th and 21st Streets
- High ceilings with abundant sunlight
- Open storefront large display windows
- Hardwood floors
- New ADA bathroom
- Storage
- Located on one of the best blocks of Valencia Street near Mission Picnic, Mixt, Reformation, Smitten Ice Cream, Ritual Coffee, Dog Eared Books, and more.
- Close proximity to public transportation, including MUNI and the 16th and 24th Street BART stops.



962 VALENCIA - FEATURES



FLOOR PLAN

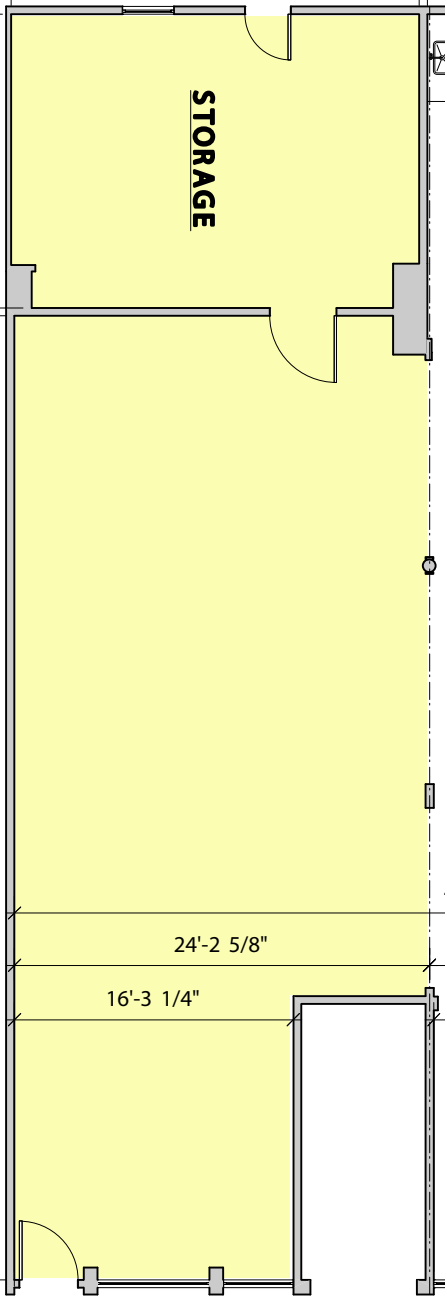

RHEA'S DELI & MARKET

NEIGHBORHOOD

THE BEEHIVE

BORDERLANDS BOOKS

CAFE ETHIOPIA

THE WOODS

REFORMATION

962 VALENCIA
SAN FRANCISCO



LOLO

BOBA GUYS MISSION

THE BREW COOP

AMNESIA BEER & MUSIC HALL

GOURMONADE

MIXT

BAGGU

GARDEN CREAMERY

XANATH ICE CREAM

DOSA ON VALENCIA

CHASE BANK

EL TECHO

ALAMO DRAFTHOUSE

WELLS FARGO BANK

REVOLUTION CAFE

CAVA22

MISSION MINIS

BOOGALOOS

RADIO HABANA SOCIAL CLUB

VERIZON

SPRINT

GRAY AREA/GRAND THEATRE

LOLO

LIMON ROTISSERIE

LOLO

MISSION MINIS

BOOGALOOS

BERETTA

LIMON
ROTISSERIE

PAPALOTE



maven
RETAIL



LOLO



ALAMO DRAFTOUSE



GARDEN CREAMERY

962 VALENCIA NEIGHBORHOOD



REFORMATION



MIXT



AMENSIA



THE BEEHIVE



BOBA GUYS



BAGGU

maven
RETAIL

maven
RETAIL

962 VALENCIA

SAN FRANCISCO

maven
RETAIL

SARAH BRETT SCHWARTZ

office 415.404.6959

sarah@mavenproperties.com

DRE #01903152

JOAN RUYLE

office 415.404.7313

joan@mavenproperties.com

DRE #02006025

NOTICE: This information has been secured from sources we believe to be reliable but we make no representations, warranties, express or implied, as to the accuracy of the information. Listing broker has been given enough information to provide only a preliminary interest in the property. The materials are not to be considered fact. The information contained herein is not a substitute for thorough due diligence investigation. References to square footage, zoning, use, or age are approximate. Please contact the San Francisco Planning Department to verify zoning at (415) 558-6378, as neither broker or landlord represent that this space is suitable for your use. Tenant or Buyer must verify the information at their own expense and bears all the risk for any inaccuracies. By receiving these materials you are agreeing to the disclaimers set forth herein. DRE#01878802

466 Green Street Suite #203 | San Francisco, CA 94133 | 415.781.7700