

# 4258 PIEDMONT AVENUE

OAKLAND | CALIFORNIA



— RESTAURANT OPPORTUNITY —



# Features

Rare opportunity to lease a ground floor restaurant space in the heart of prestigious Piedmont Avenue. The space consists of approximately 2,269 Square Feet and features

a double-wide storefront, high ceilings, and full kitchen. First time on market in over a decade. Nearby neighbors include Fenton's, Timeless Coffee, Piedmont Grocery and more.







## Highlights

- +/- 2,269 SF
- Additional 255 SF of storage
- At the entrance to the upscale Piedmont neighborhood
- Full kitchen with Type I Hood
- Large seating area
- Two bathrooms
- Wide storefront with excellent visibility
- Great signage opportunity
- Long term lease possible

## Floor Plan

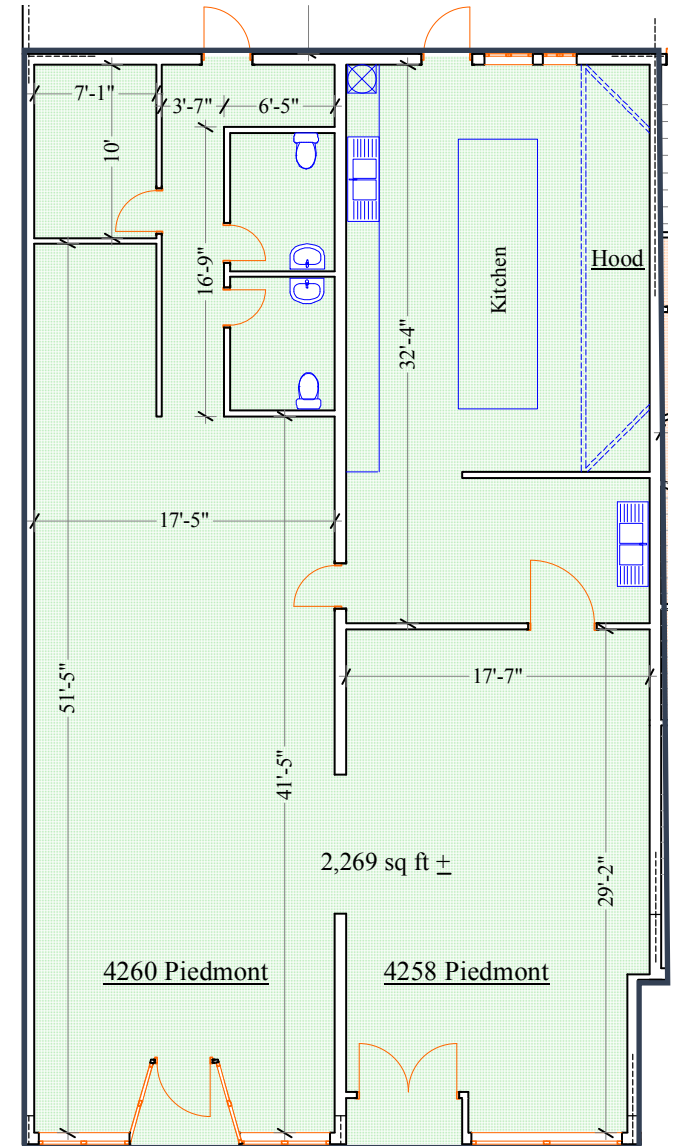



# Piedmont Avenue

Piedmont Avenue is one long sidewalk of restaurants, shops and services, stacked side by side, with nearly nothing vacant. Choices range from family-friendly, 1894-founded Fentons Creamery, which made a cameo in Pixar's Up, and the Michelin-starred Commis (2009). Indie films screen at Oakland's longest running cinema, the Piedmont Theatre, while at the more modern Cato's Ale House, sports screen on TVs as taps pour craft beers. Despite being part of the big city and having a high density of stores, Piedmont Avenue is very small-town, with a genuine magazine stand, a sewing shop with lessons (Sew Images) and a tobacconist (Piedmont Tobacconist).



**BARNEY'S GOURMET HAMBURGERS**



**FENTONS**



**LA FARINE BAKERY**



**MALIBU'S BURGERS**



**BLUE BOTTLE COFFEE**



**COMMIS**



**THE WOLF**



**THE LODGE**



**KONA CLUB**

# Neighborhood Map





# OAKLAND | CA



maven  
RETAIL

**SANTINO DEROSE** 415.415.404.7337 | [sd@mavenproperties.com](mailto:sd@mavenproperties.com) | DRE #01338326

NOTICE: This information has been secured from sources we believe to be reliable but we make no representations, warranties, express or implied, as to the accuracy of the information. Listing broker has been given enough information to provide only a preliminary interest in the property. The materials are not to be considered fact. The information contained herein is not a substitute for thorough due diligence investigation. References to square footage, zoning, use, or age are approximate. Please contact the San Francisco Planning Department to verify zoning at (415) 558-6378, as neither broker or landlord represent that this space is suitable for your use. Tenant or Buyer must verify the information at their own expense and bears all the risk for any inaccuracies. By receiving these materials you are agreeing to the disclaimers set forth herein. DRE#01878802